

## SEPULVEDA ST. & GRAND AVE. CDBG

Miguel Sangalang, Exec. Director  
Bureau of Street Lighting  
Attn: Prop. 218 Section  
1149 S. Broadway, 2nd Flr.  
Los Angeles CA 90015

**PROJ ID / Elect. No.:** 5404  
**COUNCIL FILE No.:** 22-0900-S45

**Engineer:** Lang Dam

Election Division  
Attn: Jennifer Bedolla  
Piper Technical Center, 3rd FL  
Mail Stop 168

**Mailing Date:** 08/24/22  
**P.W. Hearing Date:** 10/05/22  
**Council Hearing Date:** 10/11/22

Calendar Section  
Attn: Melinda Novoa / Erika Pulst  
Room 395, City Hall  
Mail Stop 160

Councilmember Joe Buscaino  
15th District  
Room 410, City Hall  
Stop 225

	City Assmt ID	APN	Owner name	Owner address	PROPOSED ASSESSMENT
1.	15689-001	7448-029-012	KASTELAN, STEPHEN G AND MARY TRS	2946 CROWNVIEW DR RANCHO PALOS VERDES, CA 90275	\$433.93
2.	15689-002	7448-029-013	GARCIA, JOSE E	524 W SEPULVEDA ST SAN PEDRO, CA 90731	\$88.47
3.	15689-003	7448-029-014	DAVIES, ROBERT O	1326 W 37TH ST SAN PEDRO, CA 90731	\$88.47
4.	15689-004	7448-029-015	CARVALHO, ALLAN S AND SADOK V	538 W SEPULVEDA ST SAN PEDRO, CA 90731	\$115.01
5.	15689-005	7448-029-016	RUIZ, HILARIO AND MARINA TRS	1328 S CENTRE ST SAN PEDRO, CA 90731	\$132.70
6.	15689-006	7448-029-017	CLARK, FREDERICK B AND PATRICIA	1379 W PARK WESTERN DR STE 129 SAN PEDRO, CA 90732	\$88.47
7.	15689-007	7448-029-018	BENTOVOJA, PETE J TR	3424 WILSHIRE BLVD LOS ANGELES, CA 90010	\$88.47
8.	15689-008	7448-029-019	ARCHDIOCESE OF L A EDUCATION AND WELFARE CORP	3424 WILSHIRE BLVD 4TH FL LOS ANGELES, CA 90010	\$22.12
9.	15689-009	7448-029-020	ARCHDIOCESE OF L A EDUCATION AND WELFARE CORP	3424 WILSHIRE BLVD 4TH FL LOS ANGELES, CA 90010	\$88.47
10.	15689-010	7448-029-021	BIRONDO, HELEN TR	578 W SEPULVEDA ST SAN PEDRO, CA 90731	\$115.01
11.	15689-011	7448-029-022	NORMA R ACOSTA TRUST	304 N GRAND AVE SAN PEDRO, CA 90731	\$97.32
12.	15689-012	7448-029-031	IMAI, ALAN A AND KEIKO	310 N GRAND AVE UNIT A SAN PEDRO, CA 90731	\$77.41
13.	15689-012	7448-029-032	MARIO A GUTIERREZ TRUST	310 N GRAND AVE UNIT B SAN PEDRO, CA 90731	\$77.41
14.	15689-013	7448-029-024	O BRIEN, BENEDICT B CO TR	713 36TH ST MANHATTAN BEACH, CA 90266	\$115.01
15.	15689-014	7448-029-025	WILLIAM BRANDT TRUST	328 N GRAND AVE SAN PEDRO, CA 90731	\$123.86
16.	15689-015	7448-029-028	ROMAN CATHOLIC ARCHBISHOP OF L A	3424 WILSHIRE BLVD 4TH FL LOS ANGELES, CA 90010	\$72.99
17.	15689-016	7448-030-010	DOMINGUEZ FAMILY TRUST ATTN: DOMINGUEZ, RAUL & GUTIERREZ, IRENE	1311 S MEYLER ST SAN PEDRO, CA 90731	\$63.26
18.	15689-017	7448-030-011	PIMENTEL, JOSEFINE AND AMAYA, STELLA	514 N MAR VISTA AVE WILMINGTON, CA 90744	\$115.01
19.	15689-018	7448-030-012	STOR FAMILY TRUST	582 W 37TH ST SAN PEDRO, CA 90731	\$115.01
20.	15689-019	7448-030-013	RODRIGUEZ, ARMANDO AND MARIA AND CHAVEZ, HECTOR	321 N GRAND AVE SAN PEDRO, CA 90731	\$115.01

21.	15689-020	7448-030-014	MANZANO, ABELARDO AND SYLVIA J	315 N GRAND AVE SAN PEDRO, CA 90731	\$88.47
22.	15689-021	7448-030-015	LARA, ROGELIO AND EVA	612 W SEPULVEDA ST SAN PEDRO, CA 90731	\$121.65
23.	15689-022	7448-030-016	MARTINEZ, RENE R AND SALAS, MARCELA	622 W SEPULVEDA ST SAN PEDRO, CA 90731	\$115.01
24.	15689-023	7448-030-017	630 SEPULVEDA LLC	3110 BUTLER AVE LOS ANGELES, CA 90066	\$176.94
25.	15689-024	7448-030-018	GARCIA, HERIBERTO AND MARIA E	636 W SEPULVEDA ST SAN PEDRO, CA 90731	\$115.01
26.	15689-025	7448-030-019	CARRILLO, ARMANDO AND BARRIOS, ERENDIRA	644 W SEPULVEDA ST SAN PEDRO, CA 90731	\$115.01
27.	15689-026	7448-030-020	LALASH LLC	369 S DOHENY DR PMB 265 BEVERLY HILLS, CA 90211	\$115.01
28.	15689-027	7448-030-021	SUKI MYONG SONG TRUST	1338 W 221ST ST TORRANCE, CA 90501	\$115.01
29.	15689-028	7448-030-022	TEMLADOR, DANIEL	5529 BLACKTHORNE AVE LAKEWOOD, CA 90712	\$115.01
30.	15689-029	7448-030-023	SOLORZANO, GUILLERMO AND MARIA	670 W SEPULVEDA ST SAN PEDRO, CA 90731	\$88.47
31.	15689-030	7448-030-024	CONTRERAS, MANUEL A	676 W SEPULVEDA ST SAN PEDRO, CA 90731	\$115.01
32.	15689-031	7448-031-001	SILVA, RAMIRO S AND PAULA F	332 W OLIVER ST SAN PEDRO, CA 90731	\$88.47
33.	15689-032	7448-031-033	LE, TUANVU	669 W SEPULVEDA ST SAN PEDRO, CA 90731	\$88.47
34.	15689-033	7448-031-003	LEE, CECILIA W AND LEE, CHRISTOPHER M	3516 MICHELLE DR TORRANCE, CA 90503	\$88.47
35.	15689-034	7448-031-004	REYES, JOHN C AND RACHEL	7319 ORION AVE VAN NUYS, CA 91406	\$88.47
36.	15689-035	7448-031-005	DE LA PENA, MARIO AND DE LA PENA NAGLE, ELISA	1184 W 11TH ST UNIT 4 SAN PEDRO, CA 90731	\$115.01
37.	15689-036	7448-031-006	ROMAN, MAURILIO AND BEATRIZ AND ROMAN, GERARDO	643 W SEPULVEDA ST SAN PEDRO, CA 90731	\$115.01
38.	15689-037	7448-031-007	HERNANDEZ, FREDDY AND LAURA	639 W SEPULVEDA ST SAN PEDRO, CA 90731	\$115.01
39.	15689-038	7448-031-008	NORTON, JAMES W JR	4386 W 181ST ST CLEVELAND, OH 44135	\$331.76
40.	15689-039	7448-031-024	RODRIGUEZ, DAVID AND TERESA G	1102 W CRUCES ST WILMINGTON, CA 90744	\$123.86
41.	15689-040	7448-031-023	VALVERDE, DAMIAN E AND MCCAMEY, KATHLEEN	672 W SANTA CRUZ ST SAN PEDRO, CA 90731	\$88.47
42.	15689-041	7448-031-022	VILICICH, IVICA AND KATHERINE TRS	1921 W TOSCANINI DR RANCHO PALOS VERDES, CA 90275	\$115.01
43.	15689-042	7448-031-021	ISAAC RODRIGUEZ JIMENEZ TRUST	656 W SANTA CRUZ ST SAN PEDRO, CA 90731	\$115.01
44.	15689-043	7448-031-020	LUQUE, CELESTINO	650 W SANTA CRUZ ST SAN PEDRO, CA 90731	\$115.01
45.	15689-044	7448-031-019	RODRIGUEZ, FRANCISCO AND RODRIGUEZ, BEATRICE	644 W SANTA CRUZ ST SAN PEDRO, CA 90731	\$132.70
46.	15689-045	7448-031-018	JOE BECK TRUST	652 W 9TH ST SAN PEDRO, CA 90731	\$132.70
47.	15689-046	7448-031-016	CALIXTO, GERALD M	630 W SANTA CRUZ ST SAN PEDRO, CA 90731	\$88.47
48.	15689-047	7448-031-015	HENSLEY, DAVID AND KATHERINE TRS	PO BOX 94685 PASADENA, CA 91109	\$115.01
49.	15689-048	7448-031-014	CASTILLEJOS INC C/O C/O UNION NATIONAL BROKERAGE INC	2377 CRENSHAW BLVD STE 130 TORRANCE, CA 90501	\$126.51
50.	15689-049	7448-031-013	MARTINEZ, ALFREDO	213 N GRAND AVE SAN PEDRO, CA 90731	\$115.01
51.	15689-050	7448-031-012	MADRIGAL, MARTIN AND SALCEDA, HECTOR AND LETICIA	219 N GRAND AVE SAN PEDRO, CA 90731	\$123.86
52.	15689-051	7448-031-011	RODRIGUEZ, JOSE L AND MAGDALENA	227 N GRAND AVE SAN PEDRO, CA 90731	\$115.01
53.	15689-052	7448-031-010	WILLIAM TRUST	13346 RIDGECREST LN CERRITOS, CA 90703	\$115.01
54.	15689-053	7448-031-009	BILL AND BONITA WILLIAMS TRUST	13346 RIDGECREST LN CERRITOS, CA 90703	\$97.32
55.	15689-054	7448-032-028	W INVESTMENT AND DEVELOPMENT LLC	100 S CITRUS AVE LOS ANGELES, CA 90036	\$364.94
56.	15689-055	7448-032-027	R AND P FARILLAS TRUST	831 W OLIVER ST SAN PEDRO, CA 90731	\$88.47
57.	15689-056	7448-032-026	LAWRENCE, TIMOTHY AND DAVIS, LESLIE	149 ARGONNE AVE LONG BEACH, CA 90803	\$123.86

58.	15689-057	7448-032-025	NAPPI FAMILY TRUST	2021 ELANITA DR SAN PEDRO, CA 90732	\$132.70
59.	15689-058	7448-032-024	PELCASTRE, FELIX H	590 W SANTA CRUZ ST SAN PEDRO, CA 90731	\$94.88
60.	15689-059	7448-032-023	WADE, JO ANN AND JONES, GLENN L	584 W SANTA CRUZ ST SAN PEDRO, CA 90731	\$66.35
61.	15689-060	7448-032-001	CORREA, MARIO AND MARIA	575 W SEPULVEDA ST SAN PEDRO, CA 90731	\$123.86
62.	15689-061	7448-032-002	RING, LEO O AND VIRGINIA B AND PEREZ, MAYRA E	571 W SEPULVEDA ST SAN PEDRO, CA 90731	\$88.47
63.	15689-062	7448-032-003	LITTLE HOLLOW TRUST	5219 SUNNY POINT PL RANCHO PALOS VERDES, CA 90275	\$115.01
64.	15689-063	7448-032-004	VARGAS, JUAN AND ALFARO, DAVID V	559 W SEPULVEDA ST SAN PEDRO, CA 90731	\$115.01
65.	15689-064	7448-032-005	MANUEL AND MARIA NORIEGA TRUST	549 W SEPULVEDA ST SAN PEDRO, CA 90731	\$88.47
66.	15689-065	7448-032-006	VALDERRAMA, MARTINA AND MEJIA, ANEL	545 W SEPULVEDA ST SAN PEDRO, CA 90731	\$115.01
67.	15689-066	7448-032-007	MARTINEZ, LUIS A AND CINA L	537 W SEPULVEDA ST SAN PEDRO, CA 90731	\$88.47
68.	15689-067	7448-032-008	SALCIDO, GLORIA ET AL LEMUS, JOSE S	531 W SEPULVEDA ST SAN PEDRO, CA 90731	\$88.47
69.	15689-068	7448-032-009	CASTELLON, LUIS JR	544 W 39TH ST SAN PEDRO, CA 90731	\$123.86
70.	15689-069	7448-032-010	R AND R AGRESTI TRUST	45775 INDIAN WELLS LN INDIAN WELLS, CA 92210	\$108.48
71.	15689-070	7448-032-022	GARCIA, FELIX AND ALICIA AND GARCIA, LORENA M	576 W SANTA CRUZ ST SAN PEDRO, CA 90731	\$115.01
72.	15689-071	7448-032-021	HARNER, CHARLES A	570 W SANTA CRUZ ST SAN PEDRO, CA 90731	\$115.01
73.	15689-072	7448-032-020	PONCE, LORILYNN	566 W SANTA CRUZ ST SAN PEDRO, CA 90731	\$115.01
74.	15689-073	7448-032-019	GUTIERREZ FAMILY TRUST	3419 PLEASANT VALE DR CARLSBAD, CA 92010	\$88.47
75.	15689-074	7448-032-018	RAMIREZ TRUST	550 W SANTA CRUZ ST SAN PEDRO, CA 90731	\$88.47
76.	15689-075	7448-032-017	ARMIDA COMSTOCK TRUST	552 BEAN CREEK RD LOT 1 SCOTTS VALLEY, CA 95066	\$88.47
77.	15689-076	7448-032-016	SANDOVAL, GUADALUPE AND SANDOVAL, CARLOS J	538 W SANTA CRUZ ST SAN PEDRO, CA 90731	\$88.47
78.	15689-077	7448-032-015	MORONES, JOSE G AND ELIDIA TRS	528 W SANTA CRUZ ST SAN PEDRO, CA 90731	\$115.01
79.	15689-078	7448-032-014	MOTA, SALVADOR AND VILLEGAS, MARTHA	4345 MCNAB AVE LAKEWOOD, CA 90713	\$132.70
80.	15689-079	7451-007-022	JARAMILLO, AGUSTIN ET AL GERMAN, SELENE	533 W SANTA CRUZ ST SAN PEDRO, CA 90731	\$115.01
81.	15689-080	7451-007-023	CAPINPIN, RIZALITO S	537 W SANTA CRUZ ST SAN PEDRO, CA 90731	\$88.47
82.	15689-081	7451-007-024	AVERY, JOSEPH III AND LINA	543 W SANTA CRUZ ST SAN PEDRO, CA 90731	\$115.01
83.	15689-082	7451-007-025	ROMAN, EZUEQUIEL AND MARIA A AND ROMAN, ALEJANDRO	471 W SANTA CRUZ ST SAN PEDRO, CA 90731	\$88.47
84.	15689-083	7451-007-026	ESCAMILLA, RODRIGO G AND JUANA C	555 W SANTA CRUZ ST SAN PEDRO, CA 90731	\$88.47
85.	15689-084	7451-007-027	MARIA E GASTELUM TRUST	563 W SANTA CRUZ ST SAN PEDRO, CA 90731	\$115.01
86.	15689-085	7451-007-028	JUAN G RODRIGUEZ TRUST	569 W SANTA CRUZ ST SAN PEDRO, CA 90731	\$115.01
87.	15689-086	7451-007-029	ROSADO, KRISTIN	612 W 40TH ST SAN PEDRO, CA 90731	\$123.86
88.	15689-087	7451-007-033	NEGRON, MELANIE AND DIAZ, EDWARD	132 N GRAND AVE UNIT H SAN PEDRO, CA 90731	\$38.02
89.	15689-087	7451-007-034	GUTIERREZ, JOSE L AND EMELIA	132 N GRAND AVE SAN PEDRO, CA 90731	\$38.02
90.	15689-087	7451-007-035	KNIGHT, JOSEPH A	132 N GRAND AVE NO F SAN PEDRO, CA 90731	\$38.02
91.	15689-087	7451-007-036	CHU, STEPHEN C	79 PARKTON RD UNIT 1 JAMAICA PLAIN, MA 02130	\$38.02
92.	15689-087	7451-007-037	GREENLAW, CATHLEEN A	132 N GRAND AVE UNIT A SAN PEDRO, CA 90731	\$38.02
93.	15689-087	7451-007-038	DELEON, MIGUEL A AND REGINA B	132 N GRAND AVE B SAN PEDRO, CA 90731	\$38.02
94.	15689-087	7451-007-039	PINKERTON, MIKE C AND RENTIE, ALFREDA R	PO BOX 1832 SAN PEDRO, CA 90731	\$38.02

95.	15689-087	7451-007-040	IRENE SANTISTEBAN TRUST	132 N GRAND AVE D SAN PEDRO, CA 90731	\$38.02
96.	15689-088	7451-006-027	TOBERMAN NEIGHBORHOOD CENTER INC	131 N GRAND AVE SAN PEDRO, CA 90731	\$109.48
97.	15689-089	7451-006-013	TOBERMAN NEIGHBORHOOD CENTER INC	131 N GRAND AVE SAN PEDRO, CA 90731	\$22.12
98.	15689-090	7451-006-017	TOBERMAN NEIGHBORHOOD CENTER INC	131 N GRAND AVE SAN PEDRO, CA 90731	\$22.12
99.	15689-091	7451-006-018	KINNEY, KENNETH C AND SREYDOS I	645 W SANTA CRUZ ST SAN PEDRO, CA 90731	\$88.47
100.	15689-092	7451-006-019	CHOR, KIM HUOY	7109 MINNETONKA BLVD ST LOUIS PARK, MN 55426	\$115.01
101.	15689-093	7451-006-020	CONDE, J GUADALUPE AND CUBIAS, VILMA J ET AL	661 W SANTA CRUZ ST SAN PEDRO, CA 90731	\$115.01
102.	15689-094	7451-006-021	VITO AND DAWN GIOIELLO TRUST	2752 VISTA MESA DR RANCHO PALOS VERDES, CA 90275	\$132.70
103.	15689-095	7451-006-030	DYNASTY COACHWORK INTERNATIONAL INC	133 E SAINT JOSEPH ST ARCADIA, CA 91006	\$867.86

**Total: \$11,762.81**

END - THIS LIST IS SUBJECT TO CORRECTION

CERTIFICATION OF MAILING NOTICES OF  
STREET LIGHTING MAINTENANCE

(Section 6.95 to 6.127 of the  
Los Angeles Administrative Code)

I, Ruben Flamenco, hereby certify and declare that I am and was at all times herein mentioned a Deputy City Clerk of the City of Los Angeles; that, acting for and under the direction of the City Clerk and in accordance with the direction contained in Ordinance of Intention No(s). 187579 relating to the proposed maintenance of lighting posts and appliances and furnishing of electric current thereto in the above designated lighting district, under provisions of Sections 6.95 to 6.127 of the Los Angeles Administrative Code. I, on August 24, 2022 deposited in the United States mail at Los Angeles, California, a notice entitled "Notice of Public Hearings and Ballot for Operation of Streetlights," to each of the owners of real property within the Street Lighting maintenance assessment district:

SEPULVEDA ST. & GRAND AVE. CDBG

whose names and addresses appear on the last equalized assessment roll of the County of Los Angeles, or on file in the office of, and known to the City Clerk of the City of Los Angeles and that a true copy of such notice is attached hereto and made a part hereof.

I certify (or declare) under penalty of perjury that the foregoing is true and correct. At Los Angeles, California

August 24, 2022.

Date

  
DEPUTY CITY CLERK

**SAMPLE BALLOT**

**OFFICIAL PROPERTY OWNER ASSESSMENT BALLOT**

STREET LIGHTING DISTRICT : "SEPULVEDA ST. & GRAND AVE. CDBG"

PROPERTY OWNER :

VOTE HERE

**YES, I am IN FAVOR** of the proposed Street Lighting Assessment District. I understand that I will be assessed \$433.93 annually for the operation and maintenance of the street light(s) adjacent to my property.

**NO, I am OPPOSED** to the proposed Street Lighting Assessment District. I understand that a majority NO vote will cause the streetlight(s) not to be installed.

Election: 5404  
City Parcel: 15689-001  
County APN: 7448-029-012

*I hereby declare, under penalty of perjury under the laws of the State of California, that I am the record owner, or the authorized representative of the record owner, of the parcel identified above.*

**(Both Name and Original Signature must be completed in order for your ballot to be counted.)**

\_\_\_\_\_  
PRINT NAME

(Property Owner, Authorized Rep., etc.)

\_\_\_\_\_  
ORIGINAL SIGNATURE

\_\_\_\_\_  
DATE

INSTRUCTIONS

1. Vote by marking one of the boxes on the reverse side of this ballot - Mark only one box.
2. Mark your ballot with blue or black ink – Do not use pencil.
3. Print your name, sign and date the ballot - If more than one owner, only one owner needs to sign.
4. Return the ballot using the enclosed envelope.
5. Make sure the Los Angeles City Clerk address on the back of the ballot appears in the window of the return envelope.
6. Ballot must be received by Tuesday, October 11, 2022

LOS ANGELES CITY CLERK, ELECTION DIV.  
**ATTN: 218 BALLOT ST. LTG. MNT. # 5404**  
555 RAMIREZ STREET, SPACE 300  
LOS ANGELES, CA 90099-9716

As a covered entity under Title II of the Americans with Disabilities Act, the City of Los Angeles does not discriminate on the basis of disability and upon request will provide reasonable accommodation to ensure equal access to its programs, services and activities.



# NOTICE TO PROPERTY OWNERS

FOR THE FORMATION OF THE CITY OF LOS ANGELES  
STREET LIGHTING MAINTENANCE DISTRICT:

## SEPULVEDA ST. & GRAND AVE. CDBG

NOTE: Ballots must be received by Tuesday, October 11, 2022

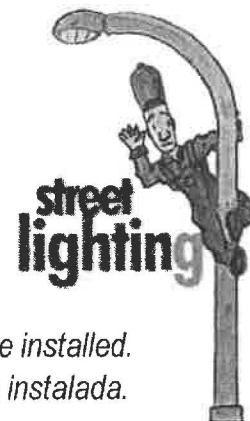

*This package contains a ballot to determine if streetlights adjacent to your property will be installed.  
Este paquete contiene una boleta de votación si a luces adyacentes a su propiedad son instalada.*

**In order to provide street lighting services near your property, an assessment district must be created to collect the annual cost for street lighting operation and maintenance from the adjacent property owners. This is your opportunity to vote (see instructions on back of ballot) on whether you want to have streetlights and accept the assessment added to your property taxes to pay for these costs.**

### NOTICE

This notice informs you, as record owner of property within the proposed assessment district, which on 8/9/22 the Los Angeles City Council declared its intention to form a new Street Lighting Maintenance District, under Council File number 22-0900-S45. All interested persons are invited to attend the public hearings and express opinions on the proposed assessment.

**Public Hearing:** Wednesday, October 5, 2022, 10:00 AM  
Board of Public Works – 3rd fl., Rm. 350, City Hall, 200 N. Spring Street.

**Council Hearing:** Tuesday, October 11, 2022, 10:00 AM  
Los Angeles City Council – 3rd fl., Rm. 340, City Hall, 200 N. Spring Street.

**Protest Procedure:** Protests presented for consideration to the Council are not binding, regardless of the number. The Council may accept or deny the protest(s) at its discretion. Any person may file a written protest or appeal with the City Clerk at any time prior to, or on the day of, the final public hearing by the City Council on this matter. Written protests shall specify the ground(s) upon which the protest is based, the name and mailing address of the person protesting, a description sufficient to identify the property for which the protest is being filed, the Council File number, and be mailed or delivered to the City Clerk, Room 395, Los Angeles City Hall, 200 N. Spring St., Los Angeles, CA 90012.

### ASSESSMENT INFORMATION

The proposed assessment described in this Notice is new and, if approved, will appear on your property tax bill. Proposition 218, the "Right to Vote on Taxes Act", was approved on the November 1996 statewide ballot, and added Article XIID to the California Constitution. It requires that a parcel's assessment may not exceed the reasonable cost for the proportional special benefit conferred on that parcel. Article XIID provides that only special benefits are assessable and the City must separate the general benefits from the special benefits. It also requires that publicly owned properties, which benefit from the improvements, be assessed.

1. **Proposed Annual Assessment (Your Property):** \$433.93 for FY 2022-23. \*
2. **Proposed Annual Assessment (Entire District):** \$11,762.81 for FY 2022-23.
3. **Duration of the Proposed Assessment:** Annually on your Property Tax Bill.
4. **Reason for the Assessment:** To pay for the cost of operating, servicing and maintaining local street lighting. These costs include, but are not limited to electricity, lamps, fixtures, poles, wires, repair crews and vehicles and other items necessary to operate streetlights in the City of Los Angeles.
5. **Balloting Results:** The District will be formed and the assessment in the amount listed on the enclosed ballot will be imposed unless a majority of the ballots are returned opposing the assessment. Ballots are weighted proportionally by each parcel's assessment amount. (\$1 = 1 vote.)



# Proposed Assessment Calculation

The process of determining maintenance assessments for each parcel is based on evaluating three areas relative to the amount of special benefit received. These include the size of the property, the land use, and the type of street lighting system(s) benefiting the property. These factors are evaluated for your property to determine your annual assessment. For more detailed information regarding assessment calculations, please visit us at: [www.lacity.org/bsl](http://www.lacity.org/bsl)

## Questions?

Call (213) 847-1500 or visit the Bureau of Street Lighting website: [www.lacity.org/bsl](http://www.lacity.org/bsl)

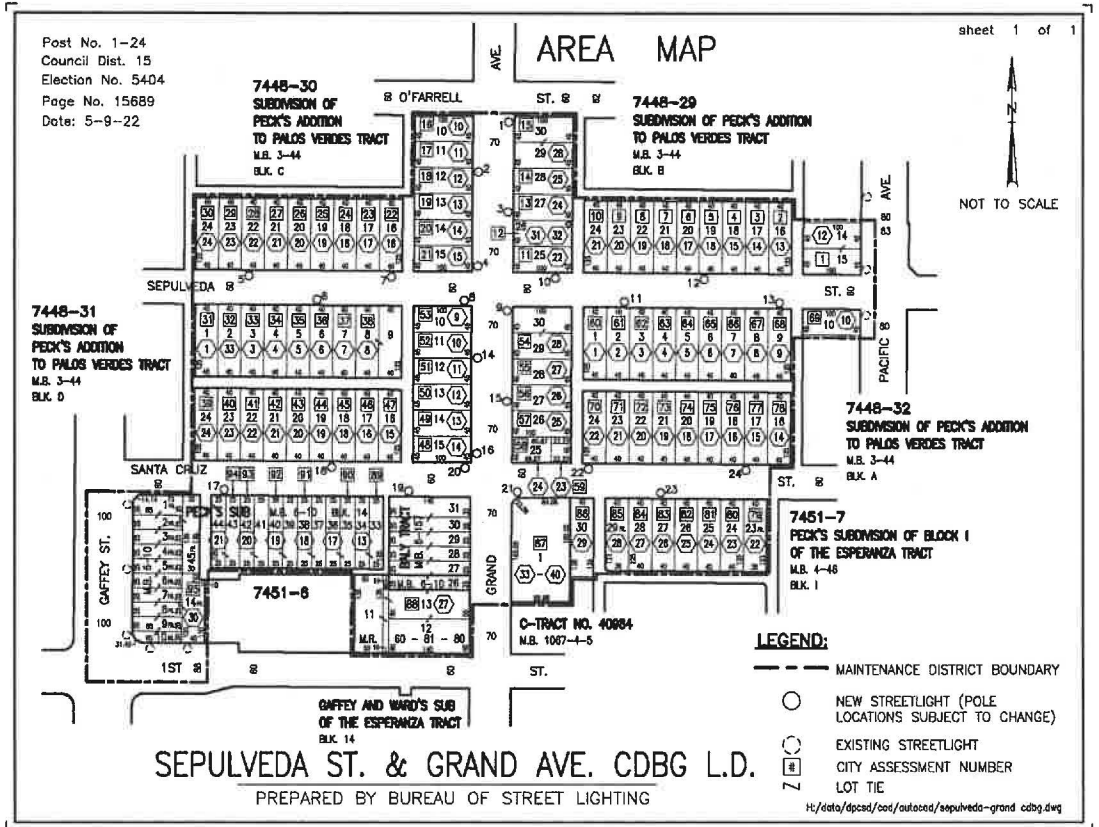

## PROPERTY and ASSESSMENT DETAILS

- Location:
- County APN: 7448-029-012
- Fiscal Year: 2022-23
- Acreage: .2070
- Land Use: COM
- Dwell Units: 1
- Current Assessment: \$220.43
- Proposed Assessment: \$433.93 \*  
(this equates to about \$36.16 per month)



\* Assessments may be increased annually without further notice or ballot, by no more than the annual Consumer Price Index (CPI) for Los Angeles area, provided by the U.S. Dept. of Labor (Bureau of Labor Statistics). The annual Consumer Price Index (CPI) will be calculated from the calendar year (Jan 1-Dec 31) just prior to the assessment period affected (Jul 1-Jun 30). Current Assessment will be replaced by Proposed Assessment.

City of Los Angeles  
Department of Public Works  
Bureau of Street Lighting





Light not yet installed.

# STREET LIGHTING BALLOT DON'T THROW AWAY

This package contains a ballot to determine if streetlights will be installed adjacent to your property.

In order to install streetlights near your property, an Assessment District must be created to collect the annual cost from adjacent property owners to operate and maintain the lights. This is your opportunity to vote on whether you want to have streetlights and accept the charge added to your property taxes to pay these costs.

In this packet you will find a blue Notice, a yellow Ballot, and an envelope for mailing the ballot.

## Street Lighting Operation and Maintenance Ballot

This ballot is the most important document in this material.  
It shows the proposed assessment amount for your property  
Ballots that are not returned, or that are returned late, cannot be counted.

**Please return your ballot!**

## Notice to Property Owners

This Notice provides you with legally required information about the balloting and the assessment. On the back, it explains how your assessment is calculated.

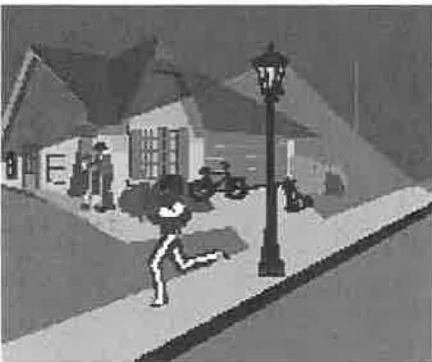

✓ A majority **YES** vote will permit the City to install streetlights near your property.

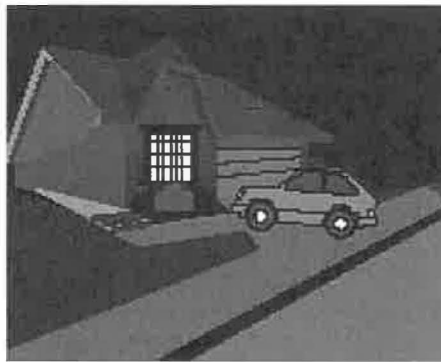

✓ A majority **NO** vote will not allow the City to install streetlights adjacent to your property.

City of Los Angeles  
Dept. of Public Works  
Bureau of Street Lighting



**Questions? Problems paying?**  
Call 213 847-1500 or visit the  
Bureau of Street Lighting website.  
<https://bsl.lacity.org>

As a covered entity under Title II of the Americans with Disabilities Act, the City of Los Angeles does not discriminate on the basis of disability and upon request will provide reasonable accommodation to ensure equal access to its programs, services and activities.

# BALOTA DE ALUMBRADO PUBLICO FAVOR DE NO TIRAR A LA BASURA

Este paquete contiene una balota para determinar si un sistema de alumbrado público será instalado adyacente a su propiedad.

Para instalar un sistema de alumbrado público cerca de su propiedad, un distrito de valoración debe ser creado para coleccionar anualmente de los propietarios la cantidad para la operación y mantenimiento del alumbrado. Esta es su oportunidad para votar si desea que el alumbrado se mantenga encendido y aceptar que los cargos se agregen a los impuestos de su propiedad.

En este paquete usted encontrará un aviso color azul, una balota amarilla, y un sobre para enviar la balota.

## Balota para la Operación y Mantenimiento del Alumbrado Público

Esta balota es el documento más importante dentro de este material.  
La balota muestra la propuesta cantidad de tasación sobre su propiedad.  
Balotas no regresadas o regresadas tarde, no pueden ser contadas.

**¡Favor de Regresar la Balota!**

## Aviso Para Propietarios

Este aviso suministra información sobre la votación y tasación requerida por la ley. Al reverso, le explica como su tasación es calculada.



✓ Una mayoría de votos "SI", permitirá a la Ciudad instalar alumbrado público cerca de su propiedad.

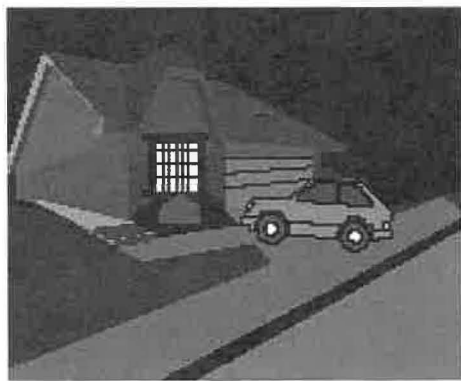

✓ Una mayoría de votos "NO", no requerirá a la Ciudad instalar alumbrado público adyacente a su propiedad.

Ciudad de los Angeles  
Departamento de Obras Públicas  
Buró de Alumbrado Público



¿Preguntas? ¿No puede pagar?  
Llame al 213 847-1500 o visite  
la página de internet del Buró de  
Alumbrado publico:  
<https://bsl.lacity.org>